

# Tate

## DAY FURNITURE

---

Sophisticated workmanship and elegant, luxurious details are the main characteristics of this important sideboard, suitable for any style and environment.



Sideboard with structure in beech wood and metal. Mahogany and bronzed finishings.

## DAY FURNITURE

Structure in beech wood and metal. Mahogany and bronzed finishings.

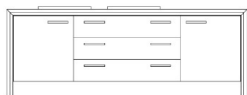

### TAT.114.A

---

Sideboard

#### Standard features

L 220 D 50 H 80 cm

L 86.61 D 19.69 H 31.5 in